



# FOR THE CONTRACTOR

## INSTALLATION INSTRUCTIONS

### POLYMER KITS BOND-FREE

#### Combination Kits

(Stainless Lid & Polymer Edge Protector)

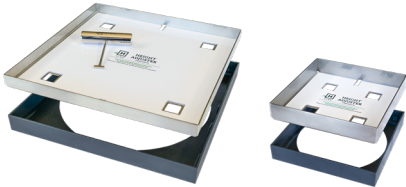

#### Full Polymer Kits

(Polymer Lid & Edge Protector)

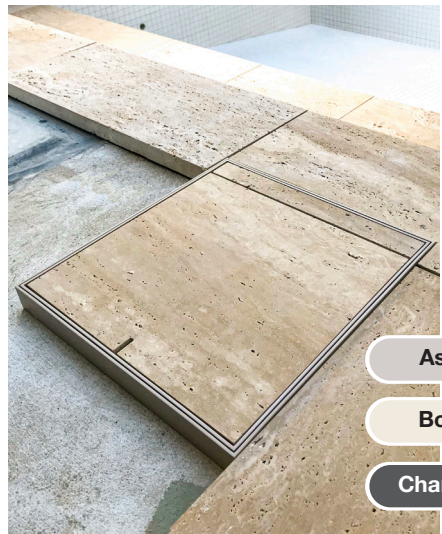
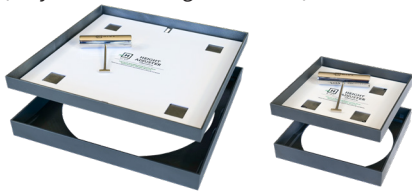

Ash

Bone

Charcoal

#### 342 Skimmer & 206 Access Cover Kits

3 Colours: Ash, Bone or Charcoal - Two depths to suit 20 and 30mm stone tile.

# ASSEMBLING THE INLAY COVER

## FITTING TILE/STONE INLAY

### 1 CUT TILE (INLAY) TO SIZE

If using tumbled/chiselled edge tile/stone cut all 4 edges for a better square edge finish.

- ⚠ Allow at least 1mm on each edge for expansion and contraction of the polymer.

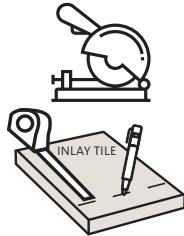

### 2 MARK UP & CUT KEYWAY AT CENTER

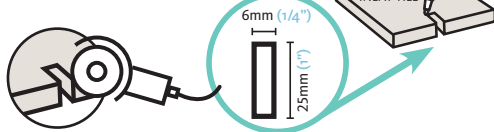

Ensure keyway is positioned on the tile edge which will be closest to the pool. Check that the key fits the keyway before gluing.

### 3 CLEAN & DRY

Failure to complete these steps may result in a weak adhesive bond.

You must insure that bonding materials are fully dry before bonding especially in cold weather.

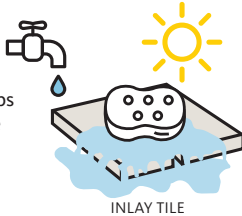

### 4 CALCULATE THE AMOUNT OF ADHESIVE REQUIRED

by measuring the difference between the internal height of the HIDE Inlay Cover and your Inlay material thickness.

$$\text{INLAY Cover internal height} \text{ MINUS } \text{INLAY (tile) height} = \text{Height difference mm}$$

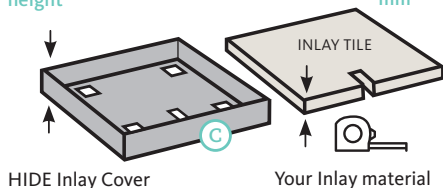

### 5 HEIGHT DIFFERENCE from step 4

IF HEIGHT DIFFERENCE IS UNDER 3mm

1 - 2mm = Qty 5 x beads 5mm wide or

2 - 3mm = Qty 7 x beads 8mm wide

(For distances over 3mm - see step 7)

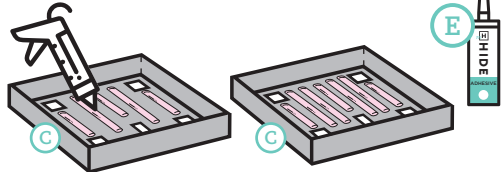

- ⚠ Avoid placing adhesive within 10mm of keyway and drainage holes.
- ⚠ Ensure the adhesive supports each corner of the inlay material.

### 6 FLIP INLAY COVER C OVER and press down onto inlay (tile):

So that both inlay cover and tile sit upside down flush on a flat surface for 15 minutes to let adhesive stiffen.

Curing time is longer in cold weather.

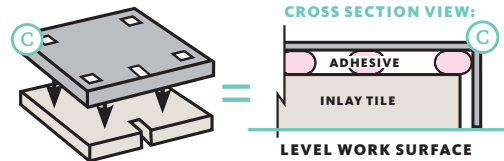

### 7 HEIGHT DIFFERENCE from step 4

IF HEIGHT DIFFERENCE IS OVER 3mm

USE THE HEIGHT ADJUSTER SUPPLIED

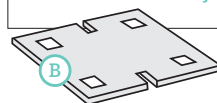

2mm Height Adjuster used allowing for two applications of Adhesive. (See step 8)

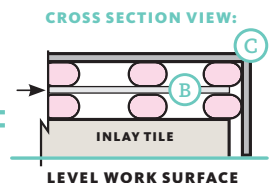

**8 HEIGHT DIFFERENCE** from step 4  
IF HEIGHT DIFFERENCE IS OVER 3mm

To calculate TOTAL adhesive to use with the Height Adjuster, remember there will be two lots of adhesive applied ie. adhesive is applied inside the Inlay Cover (C) AND the reverse side of the inlay material (tile).

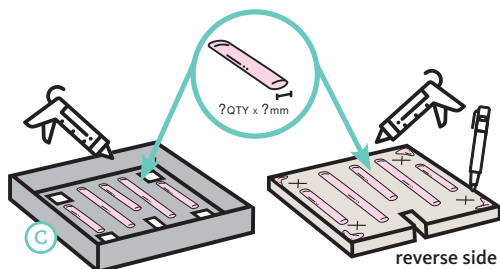

Ensure the adhesive supports each corner OF THE INLAY MATERIAL above and below the Height Adjuster.

**⚠** Avoid placing adhesive within 10mm of keyway and drainage holes.

Mark their position through the height adjuster with a cross.

**9** Place Height Adjuster on inlay (tile), then flip Inlay Cover (C) over and press down onto Height Adjuster (B):

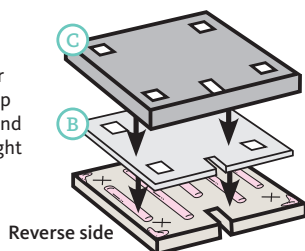

**10 PRESS DOWN FOR A LEVEL FINISH**

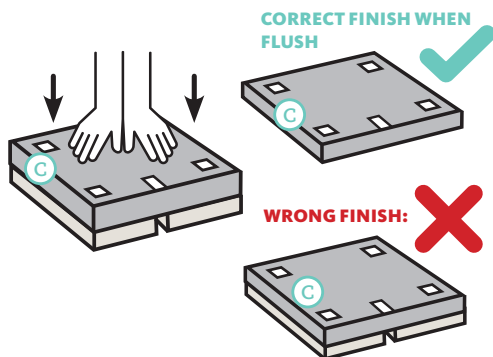

**11 WAIT WHILE ADHESIVE STIFFENS**  
See step 13 as time may vary due to temperature  
THEN FLIP RIGHT WAY UP

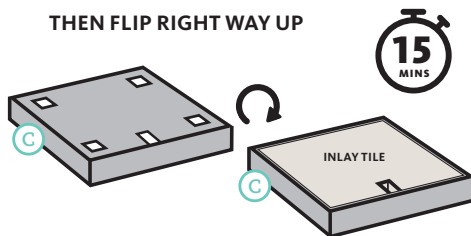

**12 CENTER TILE IN THE COVER**

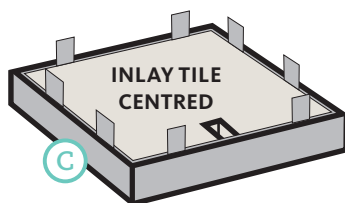

**⚠** Make sure the glue has stiffened and remains flush with the inlay cover.

Use tile spacers to center the infill and DO NOT fill the void to allow for expansion and contraction of the steel.

**13 LET ADHESIVE SET**



Adhesive should not be used in temperatures below 5°C and above 40°C. Curing time will be affected in harsh environments.

- Curing time is longer in cold weather.
- Cure in the shade in hot weather.

**14 TO FIT DECKING BOARDS**

Apply glue between timber and lid allowing for sufficient clearance for drainage.

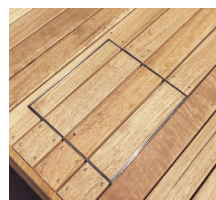

For a seamless finish, pattern match timber and grain through the inlay cover.

# INSTALLING THE EDGE PROTECTOR

## POOL PREPARATION

### NEW POOLS:

- 15 SET DEPTH** - when laying leveling bed, provide space for edge protector so it will be flush with top of installed tile.

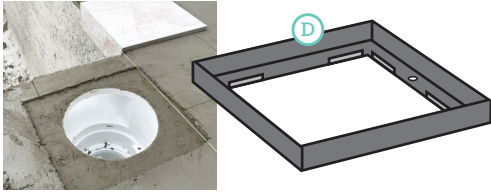

### EXISTING POOLS:

- CUTOUT** - mark outline for cutting surrounds and cut depth to match selected edge protector and a mortar bed

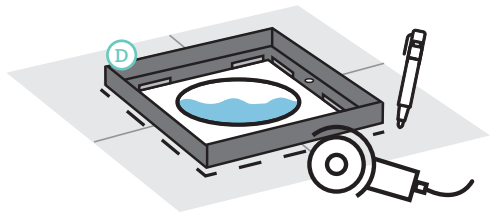

- ⚠ Ensure edge protector is centred over skimmer to mark cutting area. Allow for 1-2mm clearance on all sides.

### 16 INSTALL MORTAR

Remove debris from recess then fill recess with a mortar bed

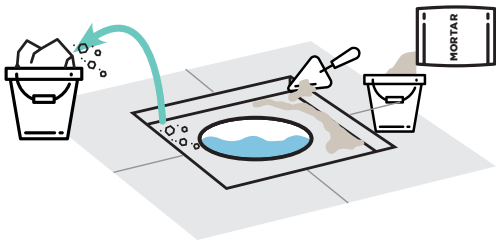

### 17 PUSH IN EDGE PROTECTOR

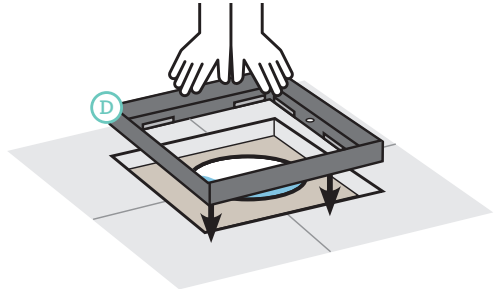

Ensure edge protector sits level with surrounds. Remove excess mortar.

### 18 ALLOW MORTAR TO SET

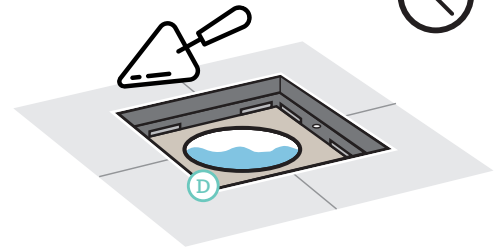

### 19 EDGE PROTECTOR

TOP VIEW OF INSTALL

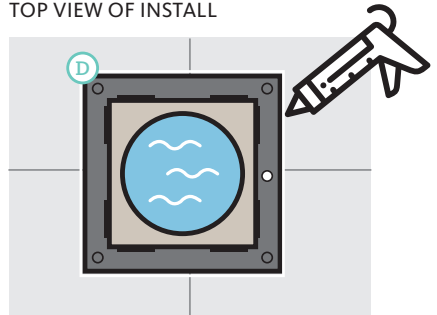

The Edge Protector may be left loose on its mortar bed or filled with an expansion joint gap filler to allow for expansion and contraction of the steel.

**WARNING!** Do not allow acid or chemical wash solutions to contact the hide product. **NOTE!** If installation varies to Skimmer Lids Pty Ltd recommendations or is used in any way other than specified, warranty and all liabilities are waived.



26 Link Drive,  
Yatala, Qld, 4207

P: +61 7 3807 2551  
M: 0427 270 560

E: [admin@skimmerlids.com.au](mailto:admin@skimmerlids.com.au)  
W: [www.skimmerlids.com.au](http://www.skimmerlids.com.au)

H I D E®